



57 Kings Elms, Barton Stacey, Winchester, SO21 3RG
Asking Price £400,000



57 Kings Elms, Barton Stacey Winchester, Asking Price £400,000

PROPERTY DESCRIPTION BY Mr Nick King

This three bedroom semi-detached family home is presented in excellent order throughout, and is extended to suit modern family living. The accommodation comprises: entrance hall, living room, kitchen, dining room, utility with cloakroom, three bedrooms and family bathroom. Externally you will find a well manicured mature garden front and rear, with gated side access to the rear garden. The property also benefits from a garage with internal courtesy door, along with ample off street parking for several vehicles.





Barton Stacey

The village of Barton Stacey is situated in the northern part of the well-known and highly regarded Test Valley which offers a church, public house, post office and an excellent primary school and nearby pre-school. There is a trout fishery with lakes offering fantastic fishing and also many walking tracks, as well as opportunities for walking at Chilbolton Common, Stockbridge Downs and Ramsbury Common. The area also offers lovely bridleways and hacking ground. Further afield to the west there is the Georgian market town of Stockbridge which offers a wide range of boutique shops, restaurants, and the Test Way which has access to open riding country. To the south off the A34 is the cathedral city of Winchester which offers a wider range of facilities, and to the northwest is Andover which also offers a wide selection of amenities including several well-known supermarkets. There is a mainline railway service from Micheldever, Andover and Winchester direct into London Waterloo in around 1 hour. Barton Stacey is also well placed for easy access onto the A303 which in turn provides links to the A34 and M3.





APPROXIMATE GROSS INTERNAL AREA = 1210 SQ FT / 112.4 SQ M
SUMMER HOUSE = 39 SQ FT / 3.6 SQ M
TOTAL = 1249 SQ FT / 116 SQ M

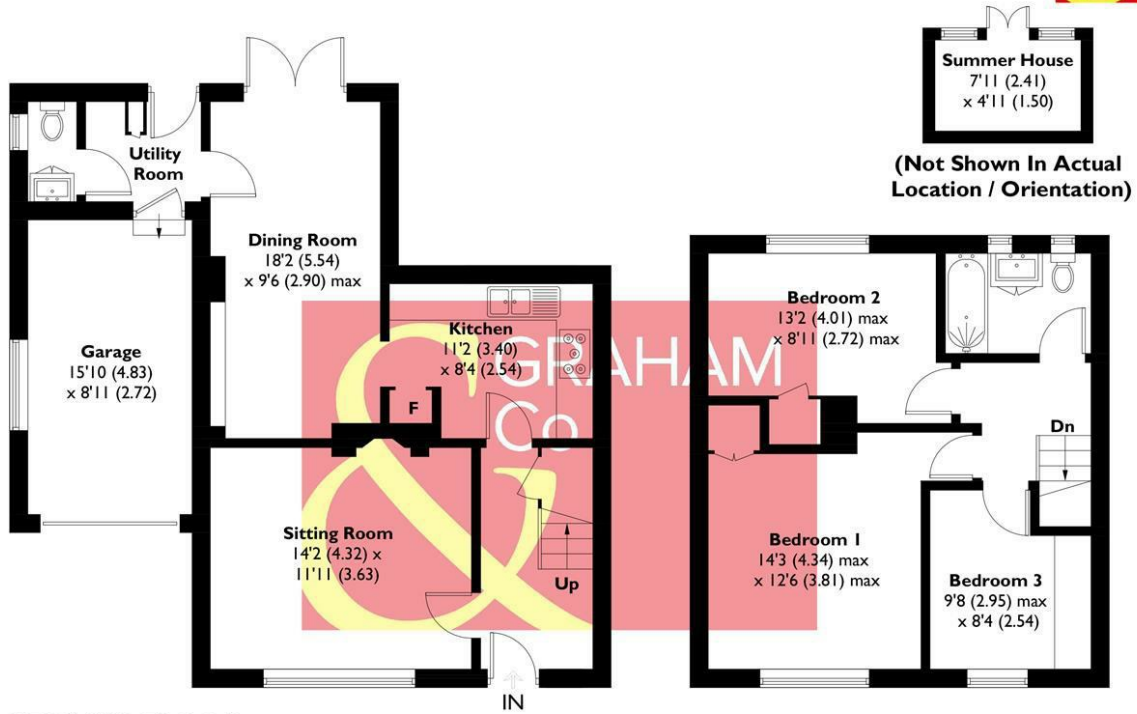

GROUND FLOOR
746 SQ FT / 69.3 SQ M
(INCLUDING GARAGE)

FIRST FLOOR
464 SQ FT / 43.1 SQ M

This plan is for layout guidance only. Not drawn to scale unless stated. Windows and door openings are approximate. Whilst every care is taken in the preparation of this plan, please check all dimensions, shapes and compass bearings before making any decisions reliant upon them. Created by Emzo Marketing (ID1268496)
Produced for Graham & Co

MORTGAGE ADVICE
Across The Market Mortgages

An independent Mortgage brokerage offering expert advice from across the whole market. Whether you are a first-time buyer, home mover, remortgaging or buying a Buy-To-Let investment. Tristan can provide expert & reliable advice, in a clear jargon free language. Book a free consultation today.

E - tristan@atmmortgages.com M - 07545320380 www.atmmortgages.com

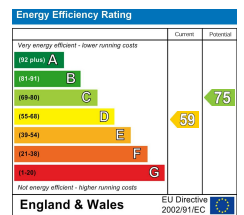

Tax Band: C



OPEN 7 DAYS

If you are considering selling your home please contact us today for your free no obligation valuation

01962 462460

IMPORTANT: we would like to inform prospective purchasers that these sales particulars have been prepared as a general guide only. A detailed survey has not been carried out, nor the services, appliances and fittings tested. Room sizes should not be relied upon for furnishing purposes and are approximate. If floor plans are included, they are for guidance only and illustration purposes only and may not be to scale. If there are any important matters likely to affect your decision to buy, please contact us before viewing the property.

